

<b>H.M. LAND REGISTRY</b> 11 DARLINGTON ROAD STOCKTON		TITLE NUMBER	
		<b>CE 125133</b>	
ORDNANCE SURVEY PLAN REFERENCE	COUNTY	SHEET	NATIONAL GRID
	CLEVELAND		NZ 4218
			SECTION
			V
Scale: 1/1250		STOCKTON-ON-TEES DISTRICT	© Crown copyright 1970

ADMINISTRATIVE AREA STOCKTON-ON-TEES

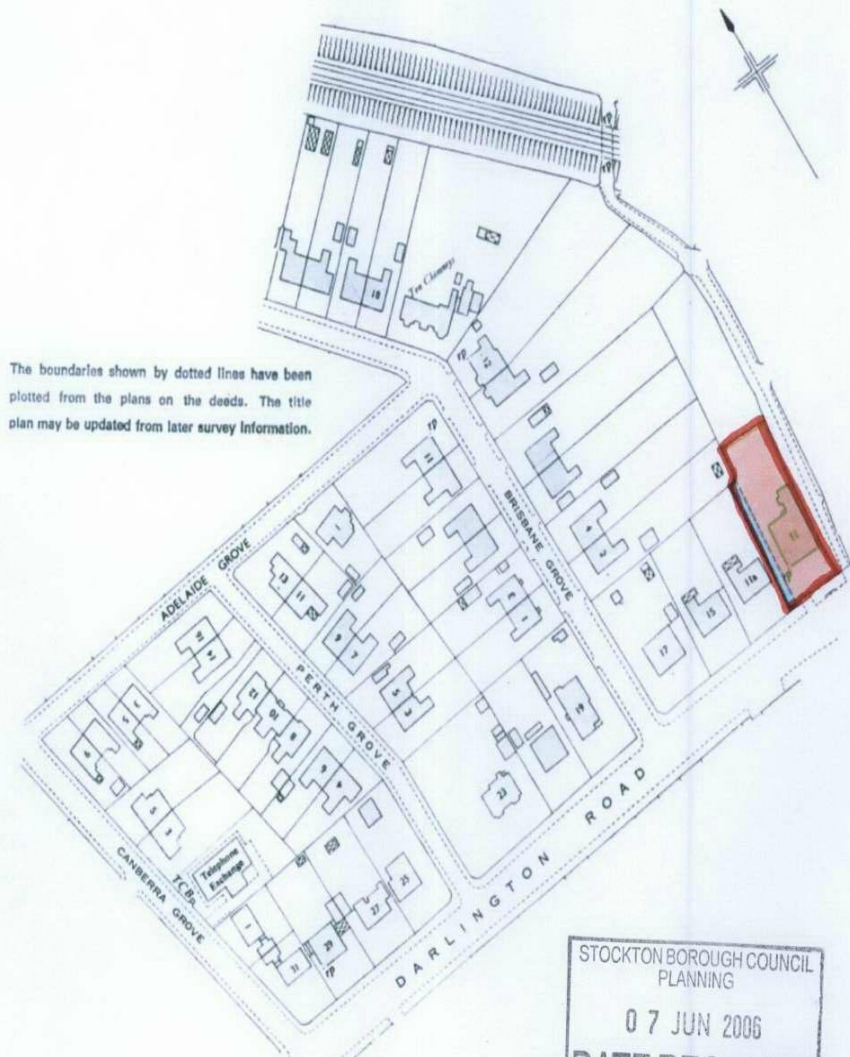

The boundaries shown by dotted lines have been plotted from the plans on the deeds. The title plan may be updated from later survey information.

STOCKTON BOROUGH COUNCIL  
PLANNING  
07 JUN 2006  
DATE RECEIVED

SBC 0001  
06/17771



This title is dealt with by Land Registry, Durham (Southside) Office.  
 This is a copy of the title plan on 20 FEB 2006 at 10:13:01. This copy does not take account of any application made after that time even if still pending in the Land Registry when this copy was issued.  
 This copy is not an 'Official Copy' of the title plan. An official copy of the title plan is admissible in evidence in a court to the same extent as the original. A person is entitled to be indemnified by the registrar if he suffers loss by reason of a mistake in an official copy. If you want to obtain an official copy, the Land Registry web site explains how to do this.  
 The Land Registry endeavours to maintain high quality and scale accuracy of title plan images. The quality and accuracy of any print will depend on your printer, your computer and its print settings. When printed, the copy plan will not necessarily be to the scale shown on the original.  
 © Crown Copyright. Reproduced by HM Land Registry. Further reproduction in whole or in part is prohibited without the prior written permission of Ordnance Survey. Licence Number: 010720728